

## TG-MA2

### Microstorage Series

#### Product Features :

- The industry's first dual cell boost solution with lower cost.
- Plug and play, no installation.
- 1000W/2000kWh long-term energy storage backup, suitable for areas with no electricity or frequent power outages.
- Impressive lifespan up to 8,000 cycles.



### What can do 1000W/2000Wh ?

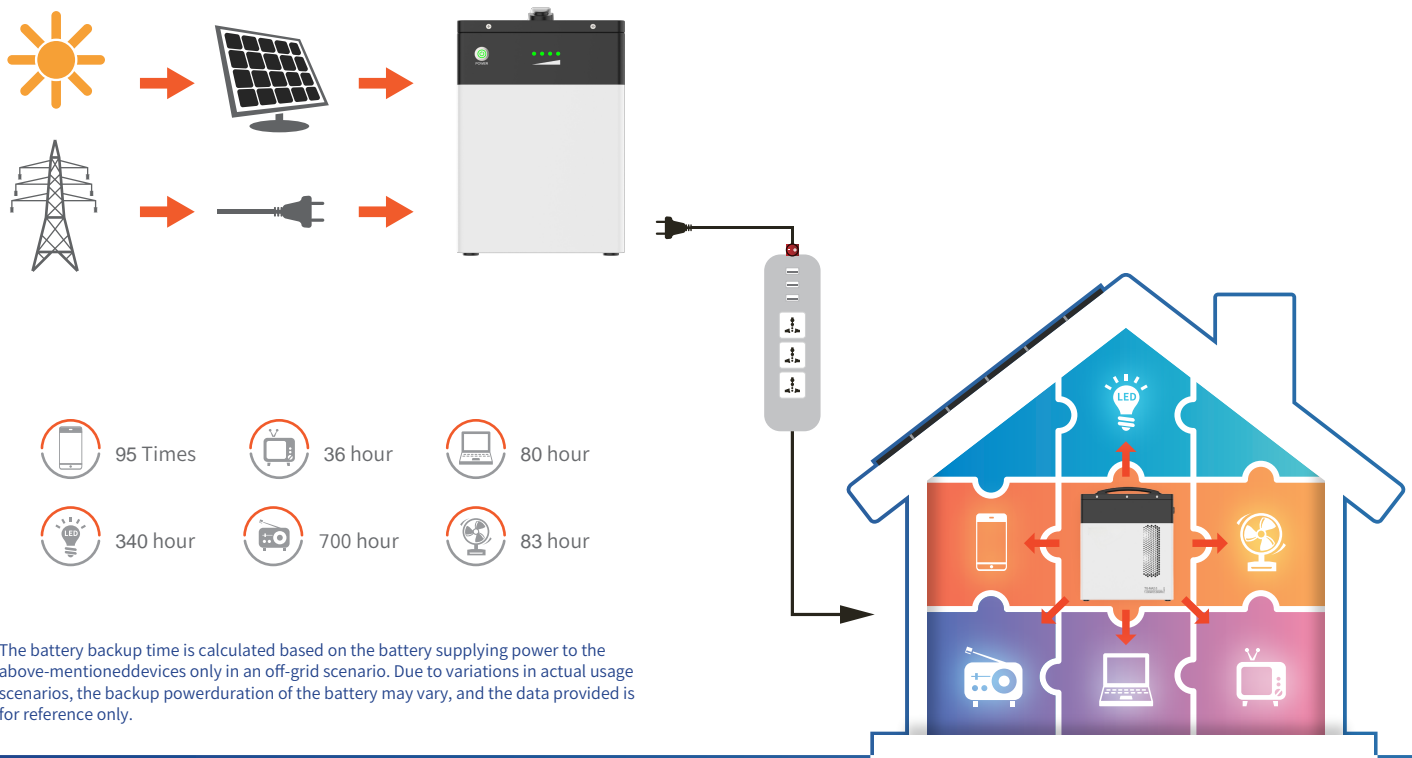

Model. No	
Cell chemistry	Lithium-iron phosphate (LiFePO4)
Battery Rated Energy	2000Wh
Battery lifespan	8000 cycles
Battery level indicator	Yes, four LEDs
AC input (Grid)	220 Vac 50/60Hz
DC input (solar)	12-60 Vdc / 500W max
AC output /Waveform	Rated Power 1000W / Pure sine-wave
Output Interface	AC 230V × 2
Protection	Overcharge & over-discharge protection / Over-voltage & under-voltage protection / Over-current protection / High&low temperature protection / Overload protection / Shortcircuit protection / Fault protection
IP protection level	IP21
Operating/ Storage Temp.	0°C to +50°C / -20°C to +50°C
Net weight	19 kg
Dimensions	280x210x300mm
Certification	CE,UN38.3, MSDS

## Energy Belongs to Everyone

Reliable & Affordable.

Convenient power solution.